

# Kor-N-Seal® II

## 206 Series Pipe-to-Manhole Connector



### KEY FEATURES & BENEFITS

- Corrugated profile for easier installation and positioning of the pipe in trench
- Designed for larger pipe sizes 18" - 51"
- Larger sizes available
- Meets the specifications of ASTM C923

The 206 Series Connector is designed with an Allen Head Wedge Bolt for easier installation of the connector into the manhole.

### KOR-N-SEAL II 206 SERIES PIPE-TO MANHOLE CONNECTOR

To fit larger sized pipe into smaller diameter manholes, please refer to our Kor-N-Seal II 306 Series Connectors.

Using Corrugated Pipe:

Adapters are required when using Corrugated Pipe.

Refer to the Corrugated Pipe Adapter Data Sheet for details.

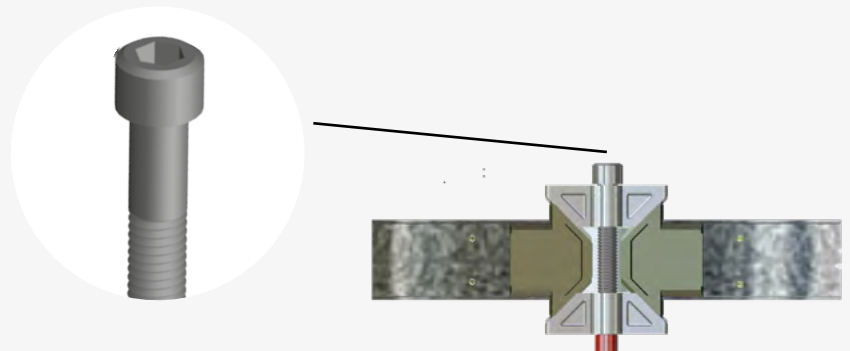

## KOR-N-SEAL II 206 SERIES PIPE-TO MANHOLE CONNECTOR

NOMINAL HOLE SIZE (inches)	MODEL NUMBER	PIPE O.D. RANGE (inches)	MINIMUM MANHOLE SIZE REQUIRED (inches)
18"	S206-18L	15.000-15.625	48/5
20"	S206-20	15.625-17.000	48/5
	S206-20L	17.000-17.625	48/5
22"	S206-22	17.625-19.000	48/5
	S206-22L	19.000-19.625	48/5
24"	S206-24A	18.000-19.500	48/5
	S206-24	19.625-21.000	48/5
	S206-24L	21.000-21.625	48/5
26"	S206-26	21.625-23.000	48/5
	S206-26L	23.000-23.625	48/5
28"	S206-28	23.625-25.000	48/5
	S206-28L	25.000-25.625	48/5
30"	S206-30	25.625-27.000	60/6
	S206-30L	27.000-27.625	60/6
32"	S206-32	27.625-29.000	60/6
	S206-32L	29.000-29.625	60/6
34"	S206-34	29.625-31.000	60/6
	S206-34L	31.000-31.625	60/6
36"	S206-36	31.625-33.000	72/7
	S206-36L	33.000-33.625	72/7
38"	S206-38	33.625-35.000	72/7
	S206-38L	35.000-35.625	72/7
40"	S206-40	35.625-37.000	72/7
	S206-40L	37.000-37.625	72/7
42"	S206-42	37.625-39.000	72/7
	S206-42L	39.000-39.625	72/7
44"	S206-44	39.625-41.000	84/8
	S206-44L	41.000-41.625	84/8
46"	S206-46	41.625-43.000	84/8
	S206-46L	43.000-43.625	84/8
48"	S206-48	43.625-45.000	84/8
	S206-48L	45.000-45.625	84/8
50"	S206-50	45.000-45.625	96/9
	S206-50L	45.625-47.000	96/9
52"	S206-52	47.000-47.625	96/9
	S206-52L	47.625-49.000	96/9
54"	S206-54	49.000-49.625	96/9
	S206-54L	49.625-51.000	96/9

Larger sizes quoted upon request.



# TRELLEBORG

[WWW.TRELLEBORG.COM/EN/SEALS-AND-PROFILES](http://WWW.TRELLEBORG.COM/EN/SEALS-AND-PROFILES)

Trelleborg Pipe Seals Milford Inc, 250 Elm Street Milford, New Hampshire 03055, USA, Tel: +1 603 673 8680, Fax: +1 603 673 7271  
Trelleborg Pipe Seals B.V., P.O. Box 62, NL-8200 AB Lelystad, Telefon +31 320 2679-79, Fax +31 320 2679-80