

Trelleborg DrainPacker Patch Kit

THE PIPE REPAIR SOLUTION THAT **EVERYONE** GETS

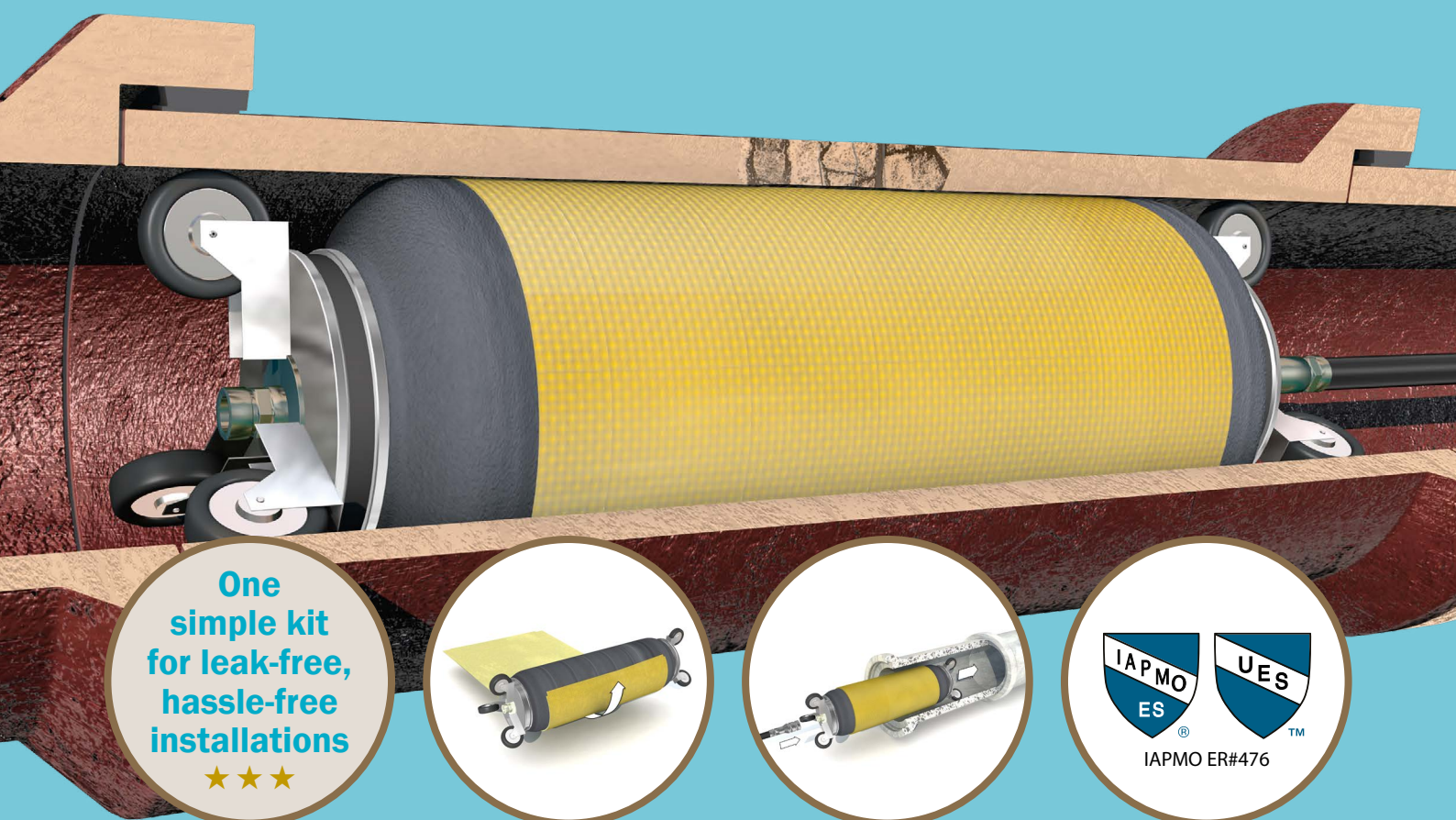

Installation instructions

Pre-installation Procedures

1. Select an **Trelleborg DrainPacker Patch Kit** in the correct configuration for the pipe to be repaired.
2. We highly recommend cleaning the pipe prior to installation with a high-pressure water jet to remove grease, roots and other deposits. The pipe surface does not need to be dry; the patch can be installed without problems even if the pipe is full of water.
3. Insert a camera into the pipe to locate and assess the damage(s). At the same time, mark the camera cable/push rod at the insertion point – this marks the distance to the repair point (for installation point 9 below).

Please follow the manufacturers safety instructions when using the Trelleborg DrainPacker Patch Kit. Ensure that eye and hand protection is used. Handle carefully and avoid direct contact with the chemicals.

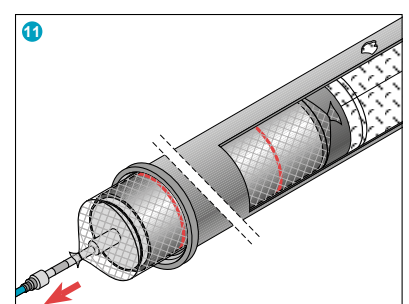
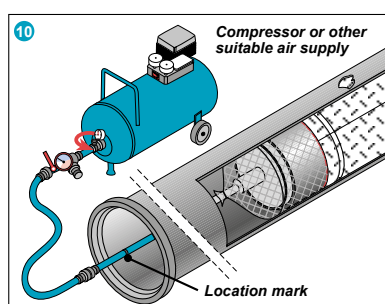
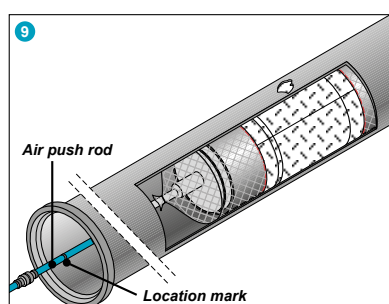
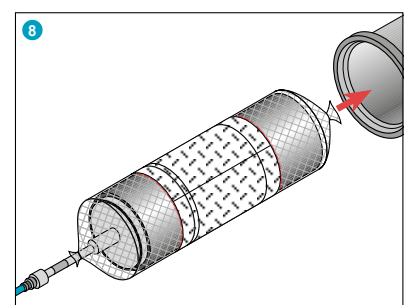
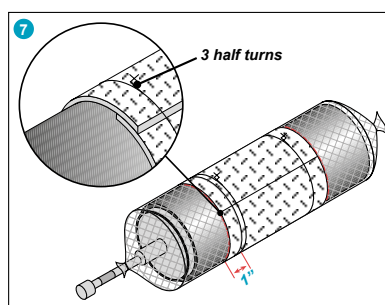
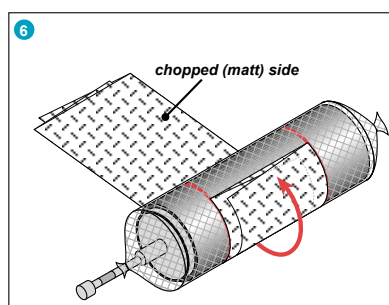
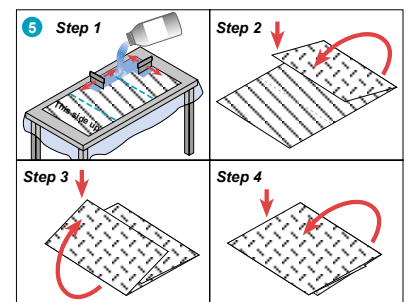
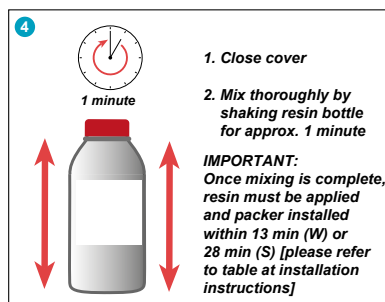
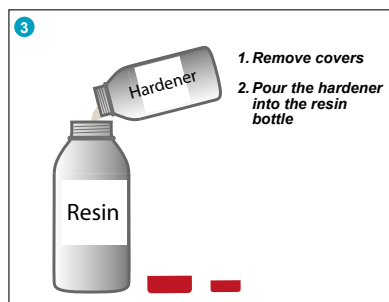
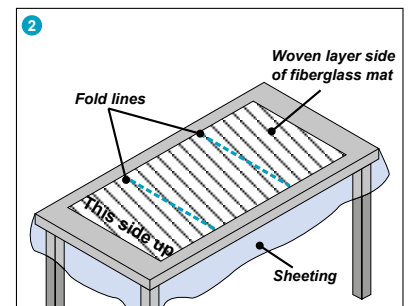
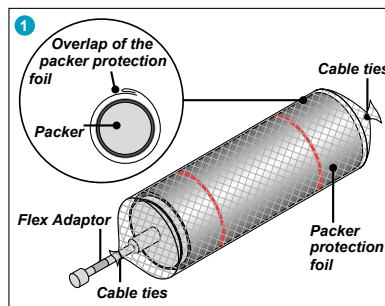

Installation Instructions

(refer to the corresponding diagrams on the left)

Ensure all items are present and to hand prior to commencing the work.

1. Pull the packer protection foil completely over the packer and secure at each end with the cable ties provided. Connect the flex adaptor to one side of the packer.

Note: Use the correct packer for the corresponding pipe diameter as recommended below.

2. Lay out the groundsheet and open out the fiberglass mat. Position as marked "This Side Up".
3. Remove the cover from both bottles and put the hardener in the resin bottle.
4. Close the resin bottle and mix thoroughly the resin by shaking the bottle for one minute.

Important: Once mixing is complete, the resin must be applied and the packer must be installed within 13 minutes (W) or 28 minutes (S) [pot time depends on resin type and temperature – please refer to table].

5. Open the resin bottle and pour part of the contents (50 – 60 %) onto the correctly positioned fiberglass mat.

Step 1: Use the spatula provided to spread the resin evenly and liberally to coat the surface.

Step 2: Fold along the first line. Pour on approximately one third of the remaining resin and spread out evenly.

Step 3: Make the second fold. Pour out approximately half of the remaining resin and spread out evenly.

Step 4: Turn over the folded impregnated mat onto the protective foil and pour on the remaining resin and spread evenly.

6. Place the impregnated fiberglass mat on the packer and centre it. Roll the mat around the packer.
7. Fix the mat onto the packer by using the provided wire ties. Position the wire ties 25 mm or 1 inch from the end of the fiberglass mat and also position additional wire ties all 60 cm or 2 ft. Secure the wire ties with 3 half turns. Slightly inflate the packer to tighten fit if needed.
8. Insert the packer and patch into the pipe.
9. Push the packer into the pipe and position it at the point of repair, as marked on the push rod during pre-installation.
10. Inflate the packer to the recommended working pressure (depending on packer type). The wire ties will release and allow the impregnated mat to be pressed against the inner surface of the pipe at the point of repair.

Note: If the pipe is badly damaged, then care must be taken when inflating the packer to avoid distorting the internal diameter of the pipe. Full pressure might not be needed.

11. Leave the packer in place and maintain the working pressure until the resin is fully cured (curing time dependent on resin type and temperature – refer to table). You can then deflate the packer and remove it from the pipe.

Equipment required in addition to the Patch Kit:

1. High-pressure water jet or similar, for cleaning the host pipe
2. Basic push camera or similar, for pipe inspection and measurement
3. Trelleborg Packer in the correct size
4. Trelleborg Push Rods and/or Pull Rope
5. Trelleborg Flex Adaptor
6. Trelleborg Pressure Regulator, including valve
7. Air compressor



Trelleborg is a world leader in engineered polymer solutions that seal, damp and protect critical applications in demanding environments. Its innovative solutions accelerate performance for customers in a sustainable way. The Trelleborg Group has annual sales of about SEK 34 billion (EUR 3.32 billion, USD 3.92 billion) in about 50 countries. The Group comprises five business areas: Trelleborg Coated Systems, Trelleborg Industrial Solutions, Trelleborg Offshore & Construction, Trelleborg Sealing Solutions and Trelleborg Wheel Systems. The Trelleborg share has been listed on the Stock Exchange since 1964 and is listed on Nasdaq Stockholm, Large Cap.

WWW.TRELLEBORG.COM/PIPE-SEALS



facebook.com/pages/Trelleborg-Pipe-Seals-Duisburg
twitter.com/PipeSeals
youtube.com/c/TrelleborgPipeSeals
<https://www.linkedin.com/company/trelleborg-pipe-seals/>